

## FSMP

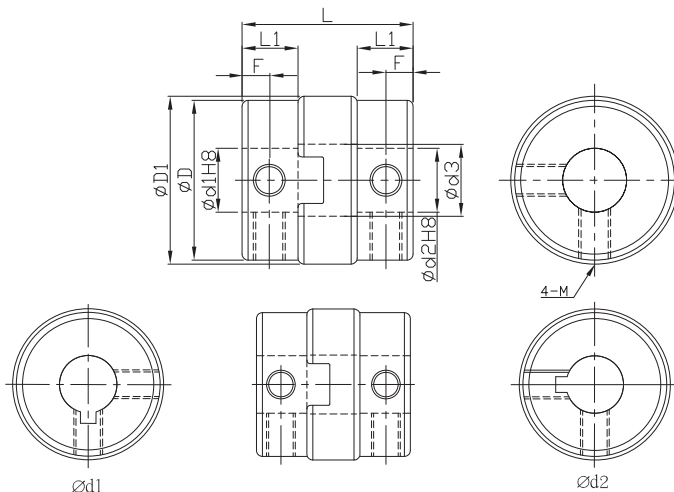

- Operating temperature : -40°C~90°C
- Offset of angular, parallel, or axial deviation are individual allowed value, so couple reasons of axial offset appearing at same time would reduce the unit allowable value.
- Available options for key way per inner diameter is bigger than 6mm. (Refer to page 38)



\*When  $\text{Ød1} < 4$  and  $\text{Ød2} > 5$ , there would be 3 set screws.  
 \*When  $\text{Ød1}$  and  $\text{Ød2}$  both smaller than 4, there would be 2 set screws.

FSMGLK (key way  $\text{Ød1}$  side)  
 FSMGRK (key way  $\text{Ød2}$  side)  
 FSMGWK (key way  $\text{Ød1}$  and  $\text{Ød2}$  side)

Component	Material	Accessories
Main frame	SUS304 Alloy	Set screw
Spacer	Carbon resin	

Dimensions		Ød1&Ød2 selection *Ød1 ≤ Ød2																		ØD	ØD1	Ød3	L	L1	F	Set screw			
Model no.	ØD	1	1.5	2	3	4	5	6	6.35	7	8	9.525	10	11	12	14	15	16	18	20							M	Lock torque (N·m)	
FSMP	6	•	•	•																	6	6.2	2.4	8.4	3	1.5	1.6	0.15	
	8	•		•	•																8	8.2	3.4	9.6	3.5	1.7			
	10			•	•	•															10	10.2	4.4	10.2	3.7	1.8			
	12				•	•	•														12	12.5	4.0	14.2	5.2	2.5	3	0.7	
	15					•	•	•	•	•	•										14.5	15	5.0	16	5.4	2.6			
	17						•	•	•	•	•	•									16.8	17.5	7.2	19.8	6.7	3.2	4	1.7	
	20						•	•	•	•	•	•	•	•	•						20	21	8.2	21.4	7	3.4			
	26							•	•	•	•	•	•	•	•	•	•					26	27	12.0	25.6	9			4
	30										•	•	•	•	•	•						30	31	13.0	33	12			6
	34												•	•	•	•	•	•	•			34	35	13.0	34.2	13	5.5	5	4.0
38												•	•	•	•	•	•	•	•		38	41	17.0	40	15	7			

★Moment of inertial torque and weight calculated by maximum diameter.

Specification		Allowable wrench torque (N·m)	Allowable misalignment			Static torsional stiffness (N·m/rad)	Max. RPM (r/min <sup>-1</sup> )	★ Moment of inertia (kg·m <sup>2</sup> )	★ Weight (g)
Model no.	ØD		Angular (°)	Parallel (mm)	Axial (mm)				
FSMP	6	0.3	3	0.3	±0.25	9	12000	1.5*10 <sup>-8</sup>	1.5
	8	0.5		0.4	±0.3	13		2.2*10 <sup>-8</sup>	2.5
	10	0.8		0.4	±0.32	21		3.6*10 <sup>-8</sup>	4
	12	1		0.5	±0.35	44	10000	1.6*10 <sup>-7</sup>	8
	15	1.6		0.8	±0.45	90		3.5*10 <sup>-7</sup>	11
	17	2.2		1	±0.55	250	7.8*10 <sup>-7</sup>	18	
	20	3.2		1.5	±0.6	340	8000	1.7*10 <sup>-6</sup>	29
	26	6		2		420	6500	6.2*10 <sup>-6</sup>	65
	30	15		2.5		1200	6200	2*10 <sup>-5</sup>	100
	34	16				2400	6000	2.5*10 <sup>-5</sup>	155
38	28		3500	5800	8*10 <sup>-5</sup>	240			

Ordering Example: FSMP26 - 8 - 10 - 100 PCS  
 Model no. Ød1 Ød2 Q'ty